



## CONVENTION CENTER GRAN VIA

Fira Gran Via is one of the largest and most modern Exhibition and Conference Centre in Europe, and also one of the most highly-rated by organisers, exhibitors and visitors from all over the world.

Designed by Pritzker Prize Japanese architect Toyo Ito, it combines a spectacular appearance with respect for the environment and provides an efficient yet creative solution to the needs of exhibitors and visitors alike.

Hall 8 is home to the Gran Via Convention Centre. Equipped with soundproof panels, its ground floor offers 14,000 m2 of flexible space to build up to 40 lecture rooms from 100 to 2,500 seats. The first floor offers 10,500 m2 for exhibition and 30 meeting rooms. The plenary room seats up to 3,600 delegates.

The adjacent halls, connected by an indoor walkway, offer the option to enlarge the expo and catering areas (up to 60,000 m2), and the plenary room (up to 5,600 seats).



# HOW TO GET THERE

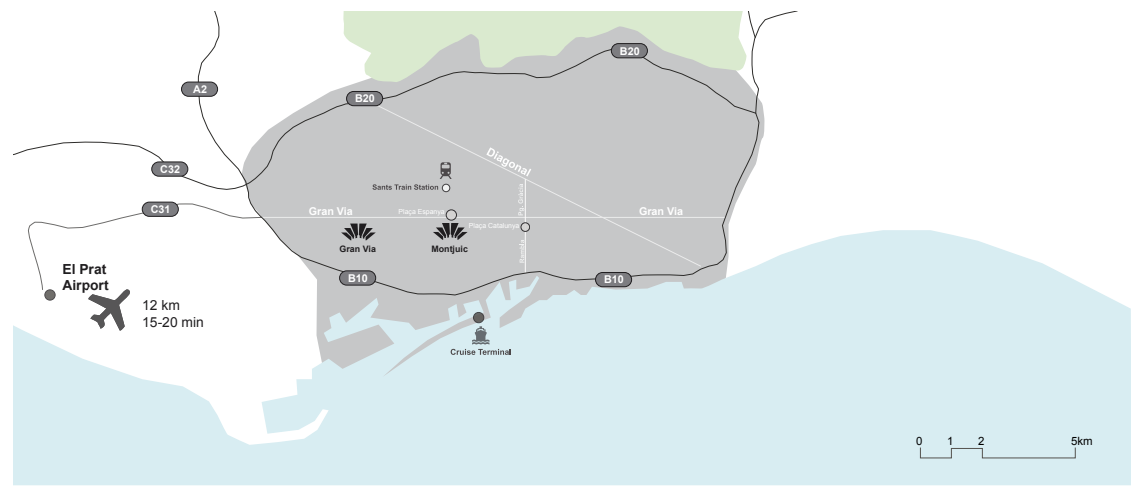

## VENUE

Located just 3 kilometers from Barcelona’s city center, Gran Via Hall 8 is ideally situated in a newly redeveloped business district. The expansive and modern venue is conveniently linked by the local public transport network to both the metropolitan downtown and nearby El Prat International Airport (12 km).

## AIRPORT

Barcelona Airport handles more than 800 flights per day to 141 destinations (30 intercontinental) and over 47 million passengers per year in 2017. Fira Gran Via is accessible directly from the airport using the new Metro Line 9, train and bus connections.

## HOTELS

Barcelona city offers more than 40,000 rooms in all categories, and has new projects for around 4,000 more to be completed in the coming years. There are some 1,345 hotel rooms built already in a walking distance around the venue, increasing to more than 5,000 rooms within a perimeter of 3km.

## TRANSPORT

Fira metro station is the solution to reach Hall 8 by public transport from the airport, the city center and surroundings. Apart from private parking facilities there is also a taxi rank in front of the main access and a shuttle bus area can be easily organised.

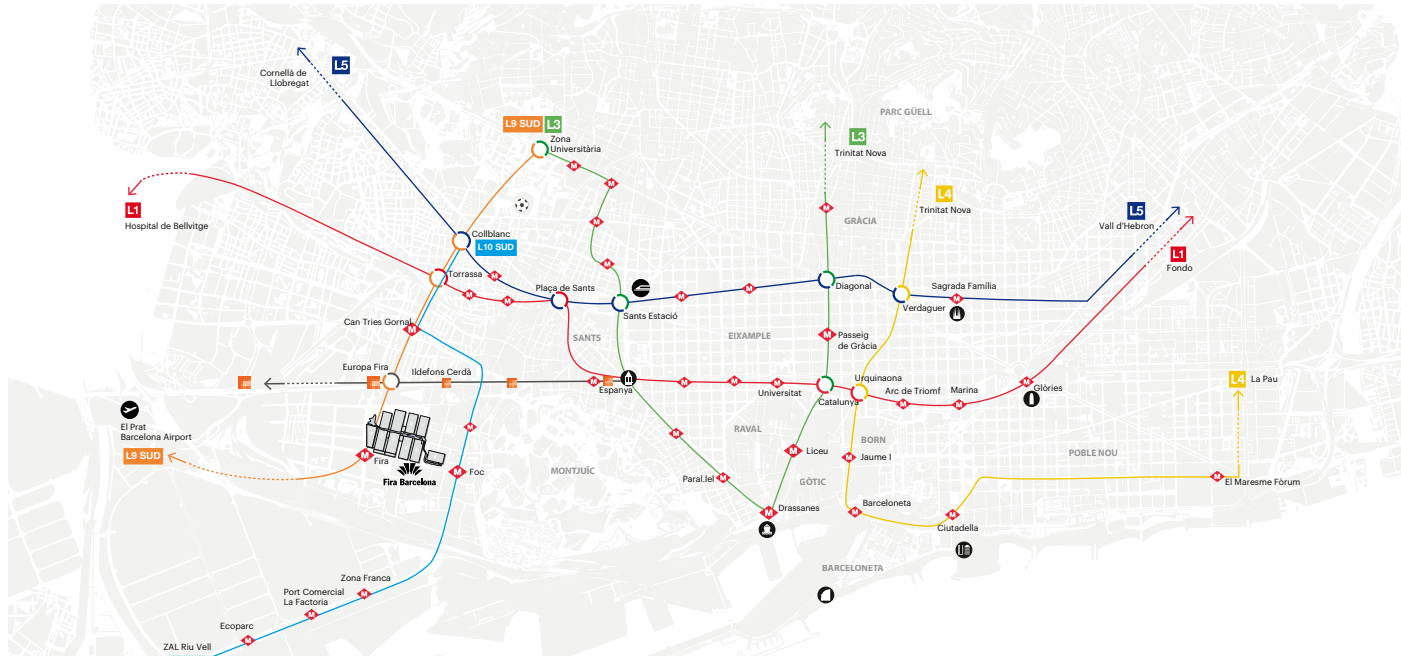

# EASY FLOW



The iconic and exclusive North Access serves as a registration area and invites visitors to get into the walkway, an easy and pleasant way to cross the venue and access to all facilities including the plenary hall, conference rooms and adjacent halls.

The outdoor green areas are ideal for networking, and digital elements displayed help enormously the attendees’ sense of direction within the venue.



## SUSTAINABILITY

The architectural design of the venue made use of various sources of natural energy with the aim of maximizing sustainability and reducing the impact on the environment. As the ultimate exponent of this trend, Fira Barcelona has a photovoltaic plant of 165,000 m<sup>2</sup> which avoids the annual emission of 2,047 tons of CO<sub>2</sub> and generates enough energy to power 980 standard family homes.



## WIFI & INTERNET

All our facilities are equipped with the most advanced installations that deliver up to 10 Gb to anywhere in the venue with a permanent overall internet throughput of 22 Gbps. At the same time, a state-of-the-art network of wireless antennae integrated in the cable network provides 802.11ac coverage to every hall to fully satisfy the technology needs of every event organizer.





VENUE OVERVIEW

| HALL | m²     |
|------|--------|
| 8.1  | 12,700 |
| 8.0  | 13,800 |
| 7    | 17,000 |
| 6    | 20,000 |
| 5    | 17,000 |
| 4    | 20,000 |
| 3    | 43,000 |
| 2    | 32,000 |
| 1    | 14,000 |

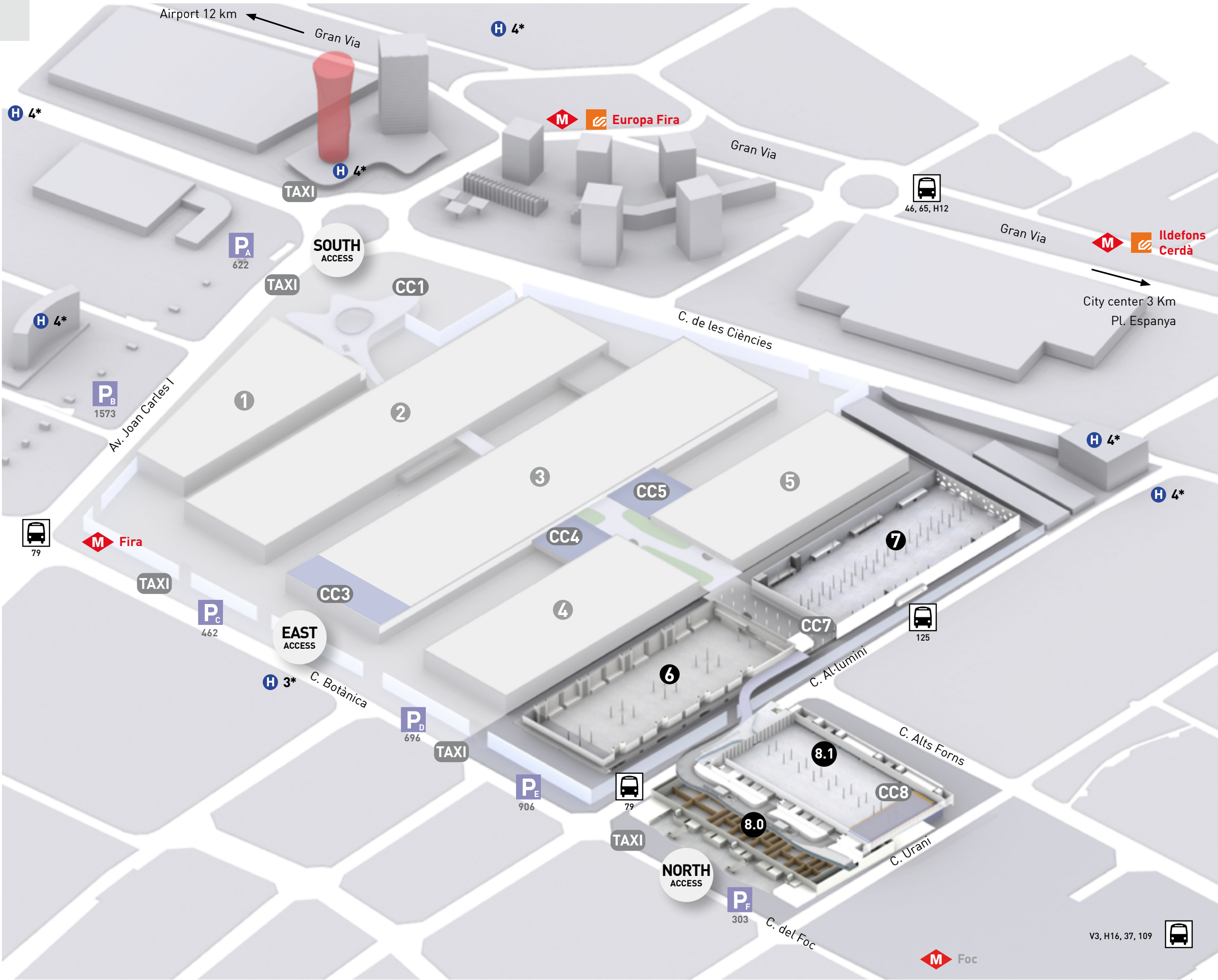

- Metro
- FGC
- BUS
- TAXI
- Parking







# NORTH ACCESS

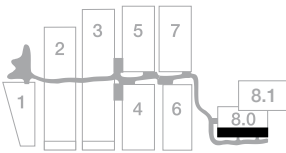

## LEVEL 0

3,000 m<sup>2</sup>

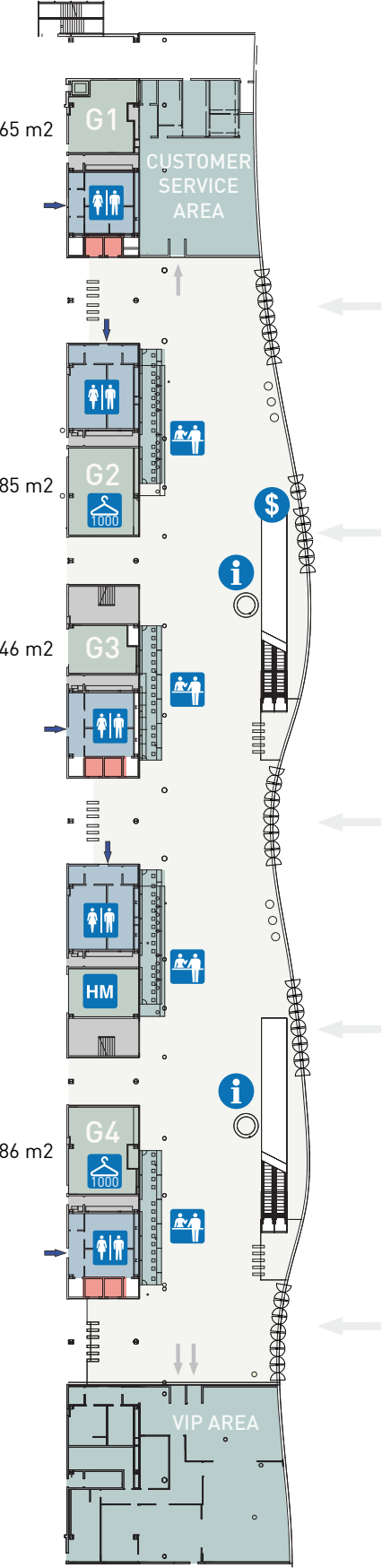

## CUSTOMER SERVICE AREA

300 m<sup>2</sup>

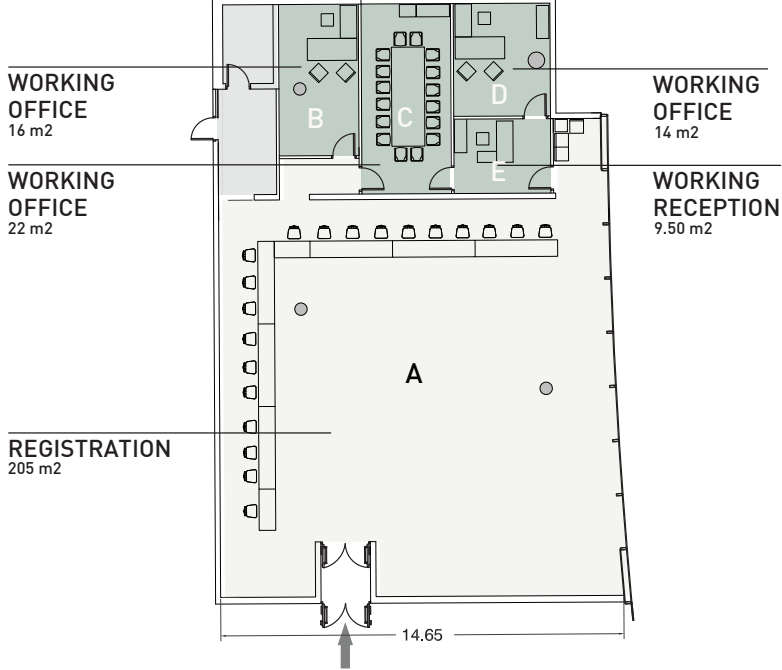

## VIP AREA

440 m<sup>2</sup>

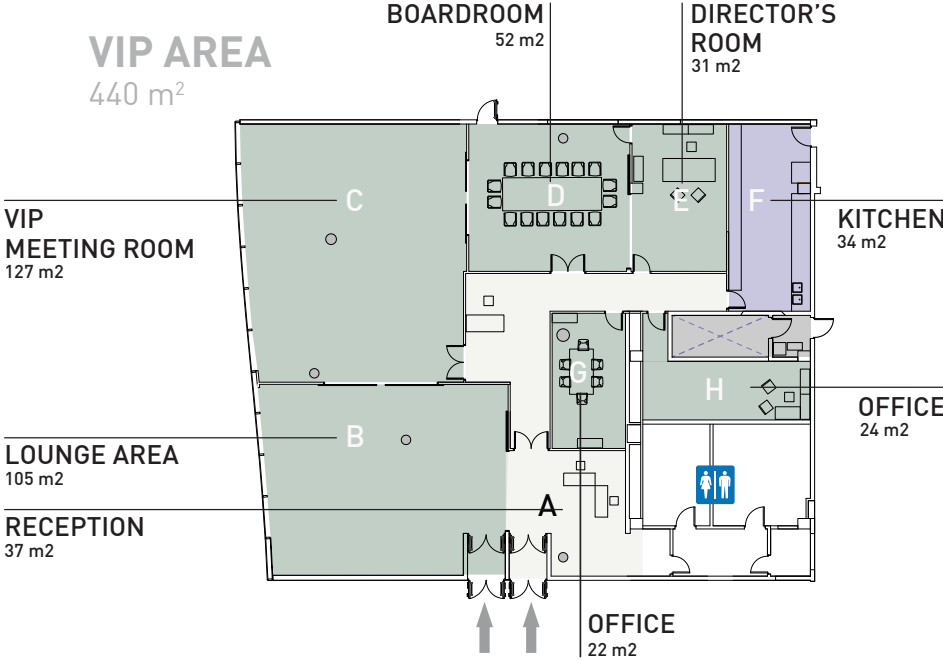

- WC
- Info point
- Registration counter
- Hall manager
- ATM

## LEVEL 1

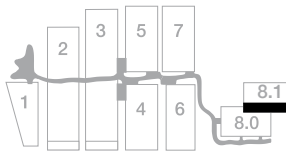
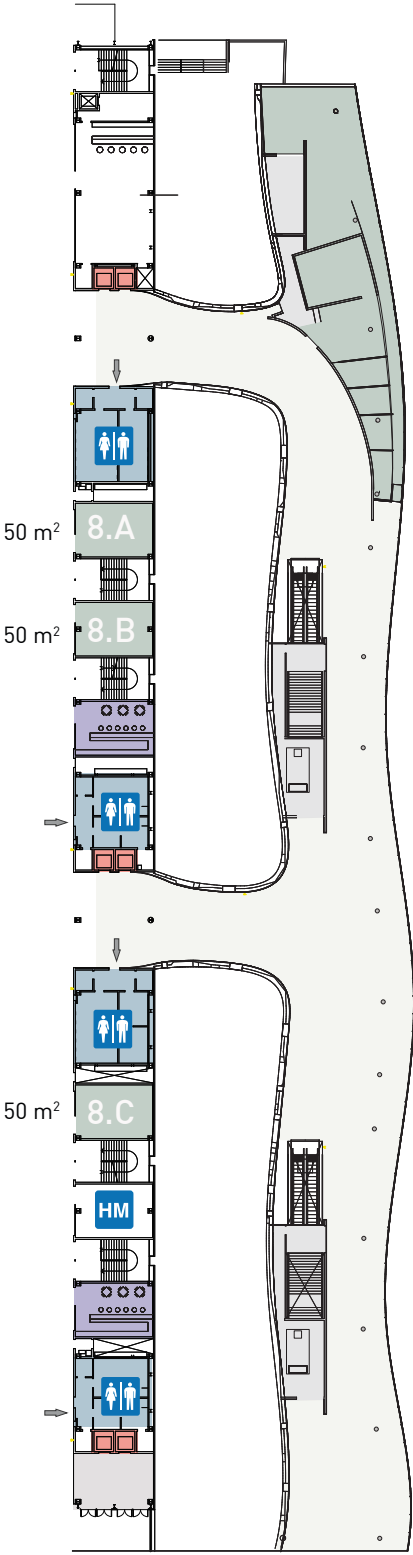

## PRESS AREA

370 m<sup>2</sup>

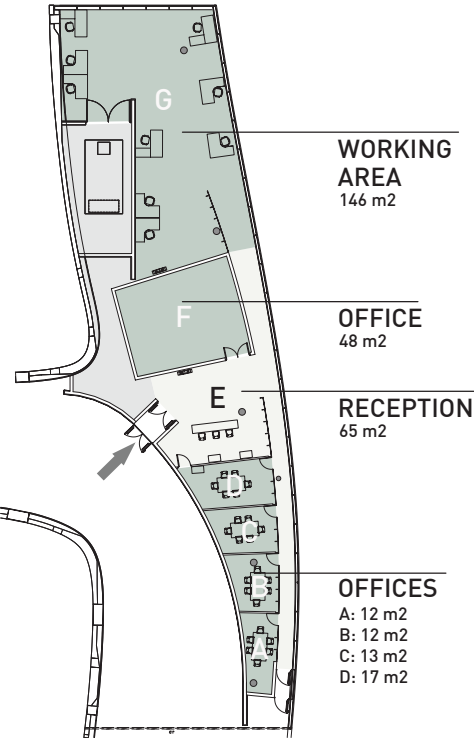



HALL 8.0

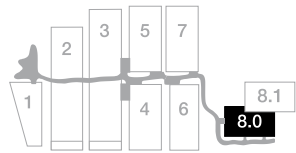

|                   |             |
|-------------------|-------------|
| Gross Surface     | 13,800 m2   |
| Ground Resistance | 3,500 kg/m2 |
| Height            | 6.70 m      |

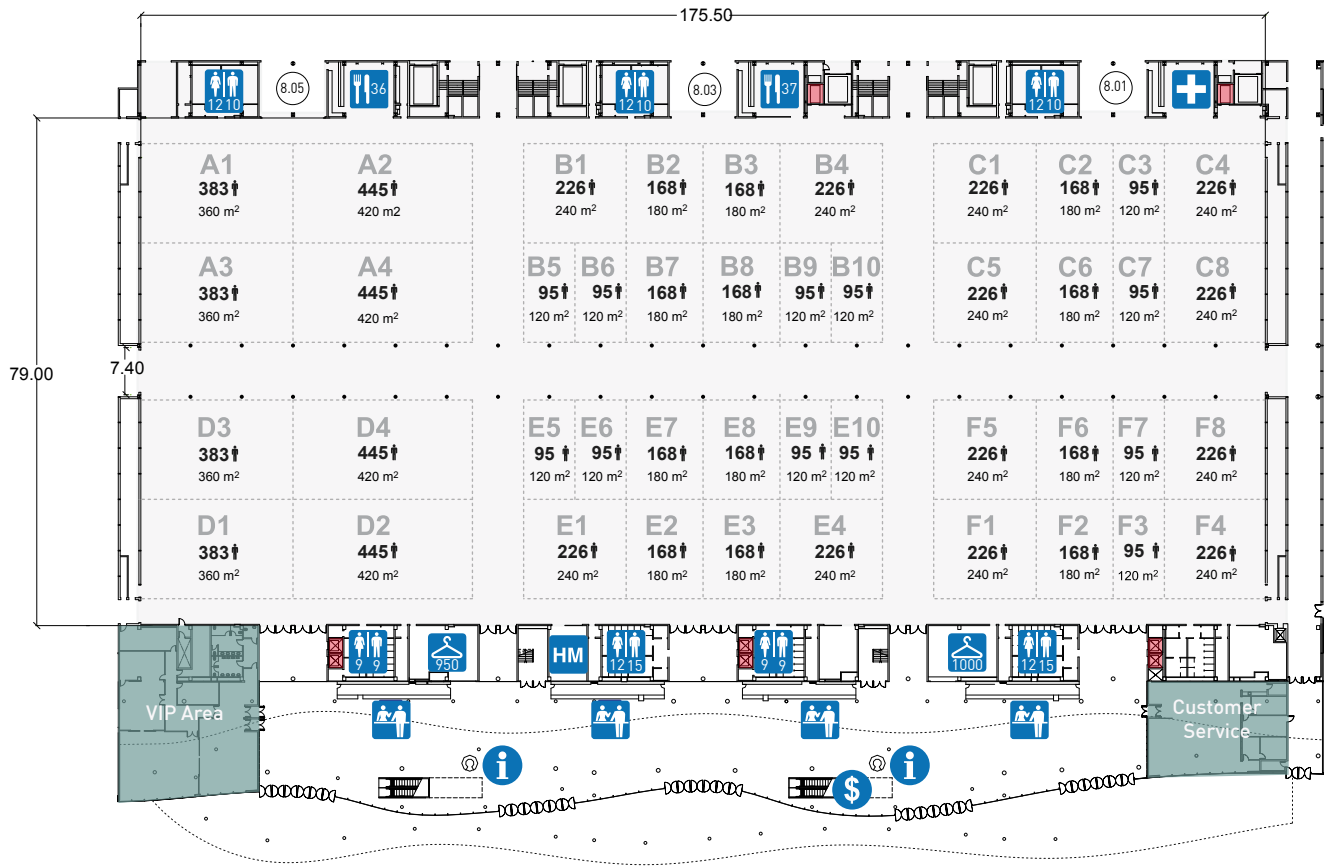

All possible divisions that can be created with the completely soundproof air wall system.  
Capacities of rooms differ from 2,500 to 100 seats in theatre style.

- First Aid
- Outlet
- Cloakroom
- WC
- Hall manager
- Info point
- ATM
- Registration counter
- Elevators

|           | INDOORS | OUTDOORS |
|-----------|---------|----------|
| Outlet 36 | 50      | -        |
| Outlet 37 | 50      | -        |

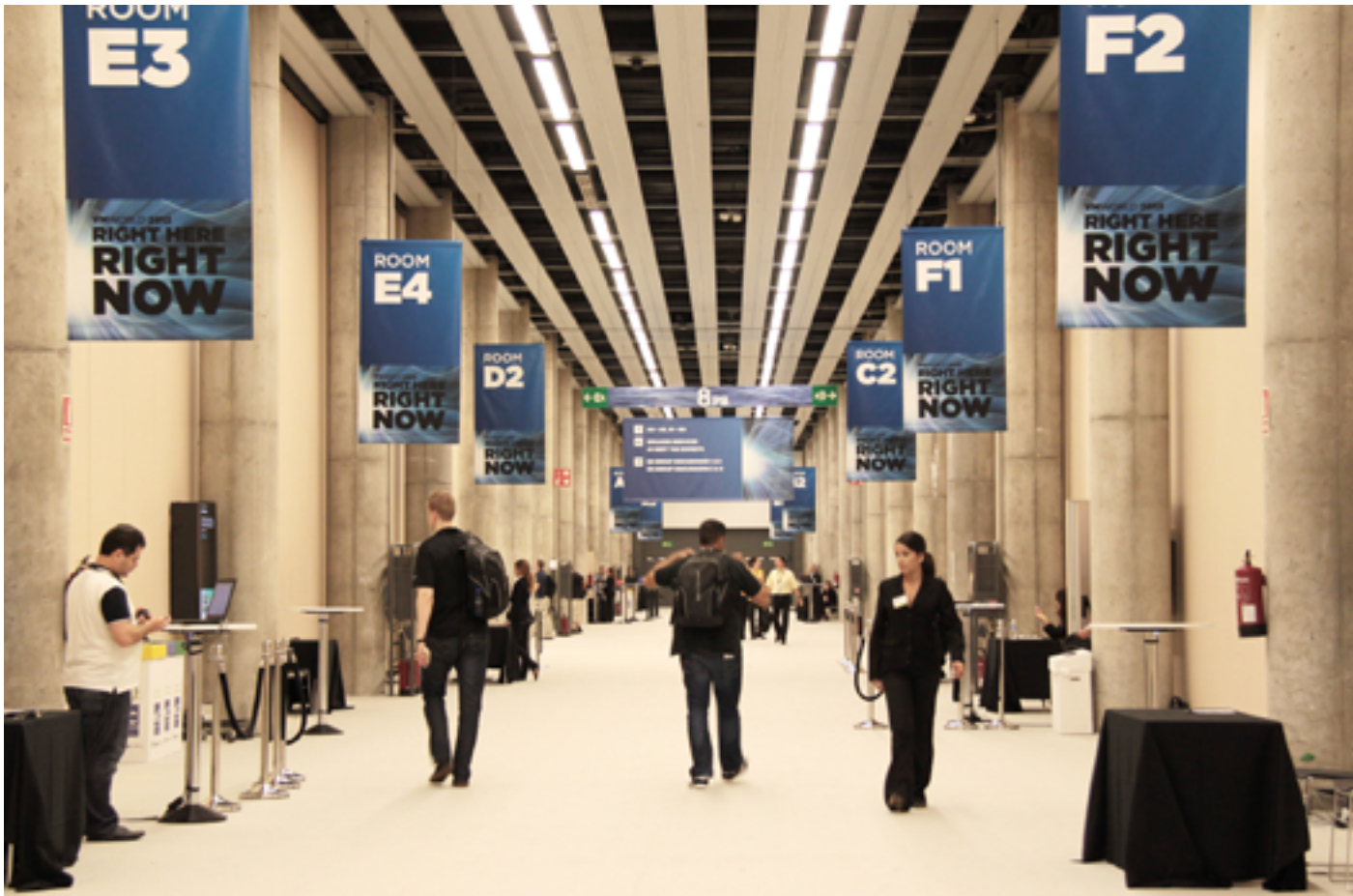
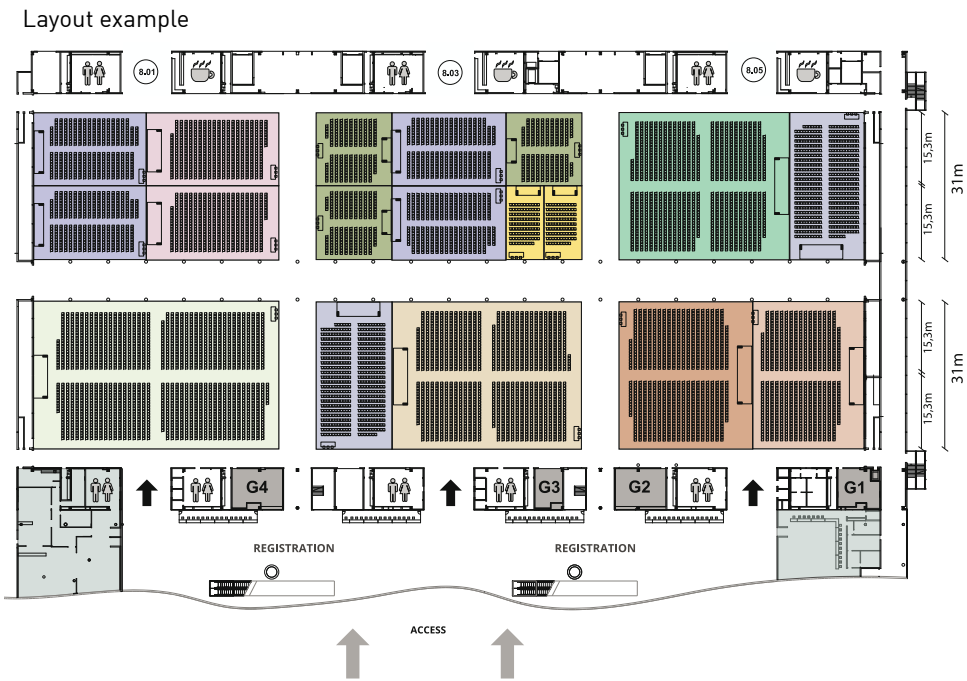



# LAYOUT EXAMPLES

## CONFERENCE

Congress for 8,000 pax  
 16 Conference Rooms  
 From 120 to 2,110 m2  
 Capacities: 90 to 2,000 pax  
 Catering Area  
 Technical dedicated area  
 Speakers Room

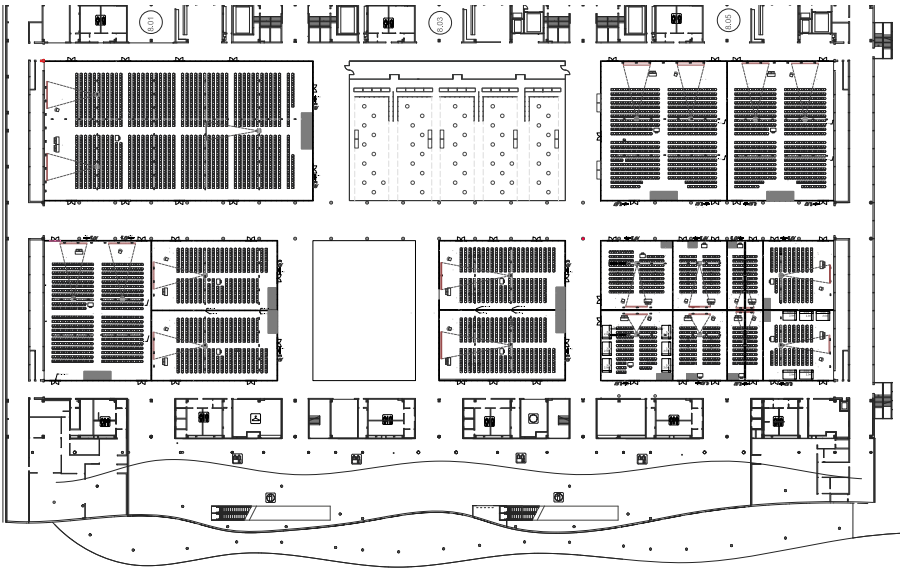

## EXHIBITION & CONFERENCE

Exhibition 7,500 m2  
 6 Conference Rooms  
 From 85 to 730 m2  
 Capacities: 25 to 460 pax  
 Reception Areas  
 Speakers Lounge



## CORPORATE

Conference for 2,000 pax  
 Cabaret 1,300 pax  
 16 Conference Rooms  
 From 180 to 800 m2  
 Capacities: 100 to 370 pax  
 Technical Area

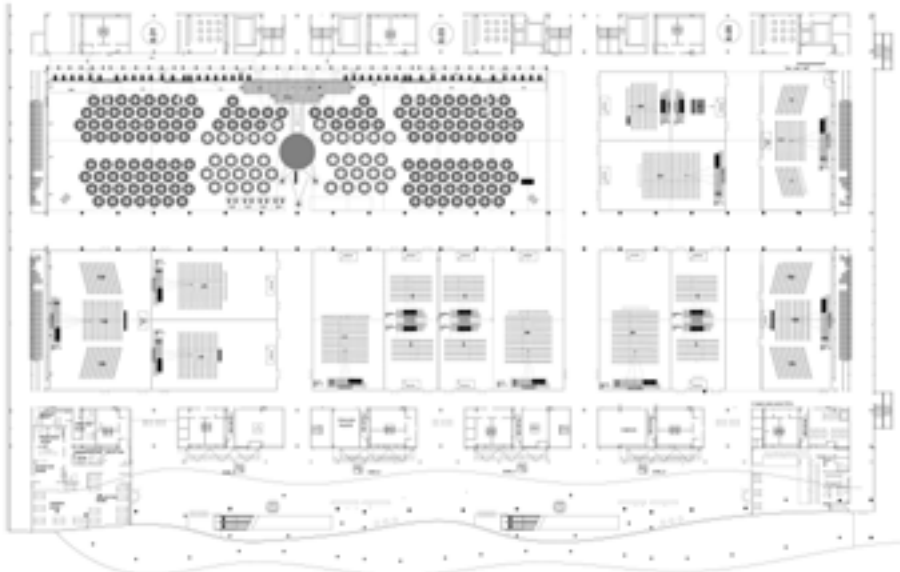



HALL 8.1

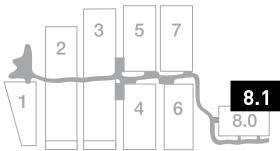

|                   |             |
|-------------------|-------------|
| Gross Surface     | 12,700 m2   |
| Exhibition Area   | 10,500 m2   |
| Ground Resistance | 1,500 kg/m2 |
| Height            | 11 m        |

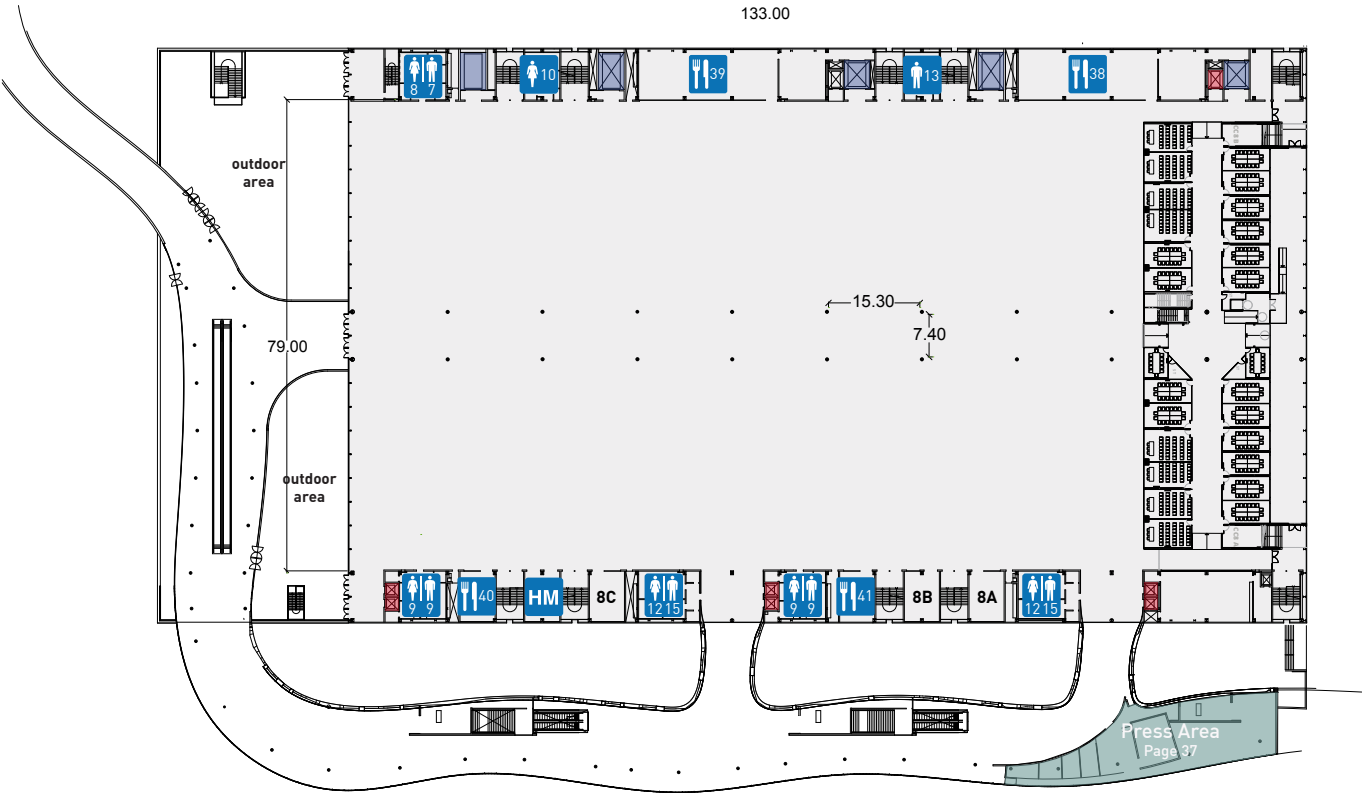

- Outlet
- WC
- Hall manager
- Goodslifts 3 units 6 ton  
2 units 4 ton

|           | INDOORS | OUTDOORS |
|-----------|---------|----------|
| Outlet 38 | 120     | -        |
| Outlet 39 | 120     | -        |
| Outlet 40 | 10      | -        |
| Outlet 41 | 10      | -        |



MEETING ROOMS CC8

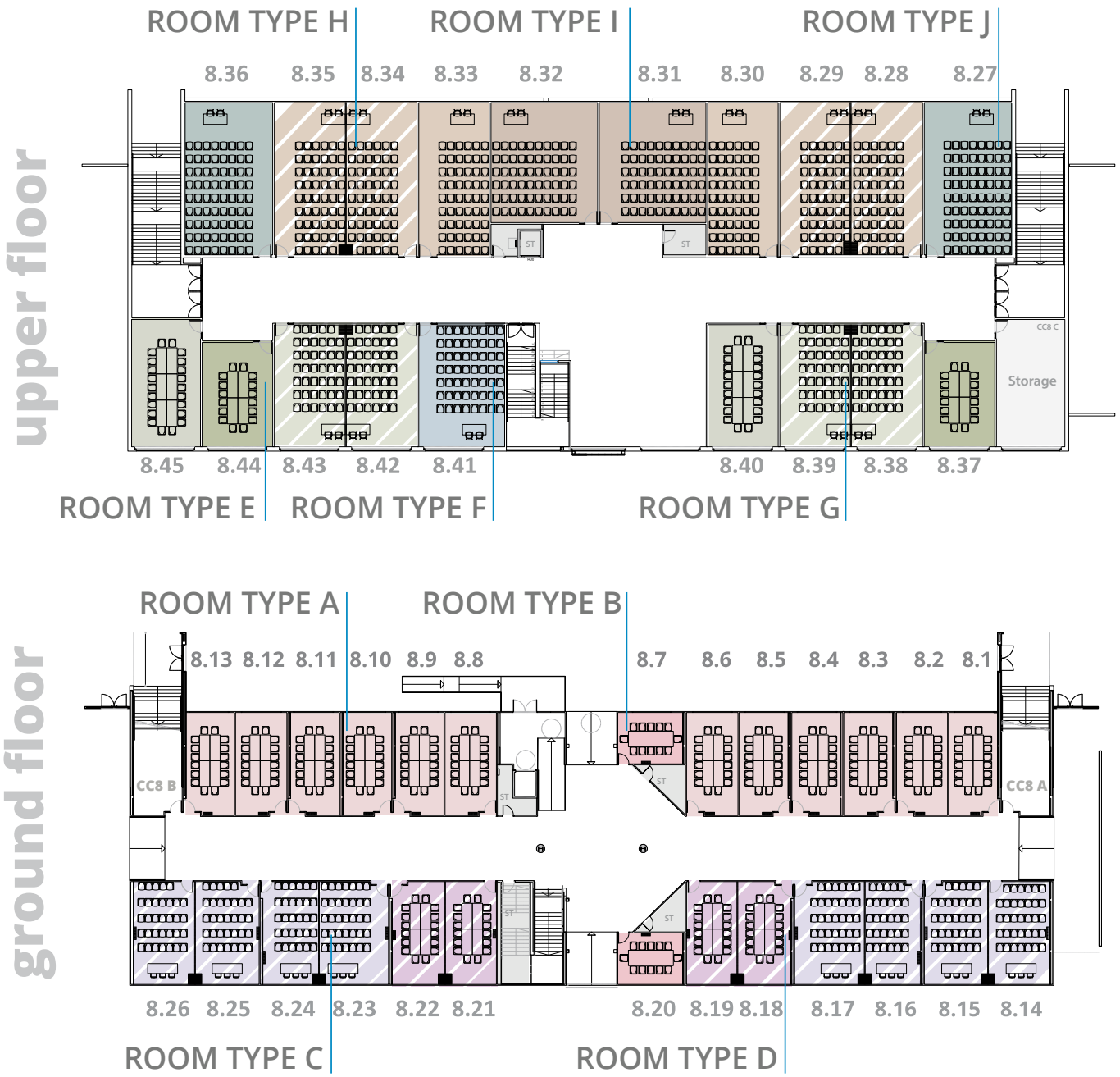
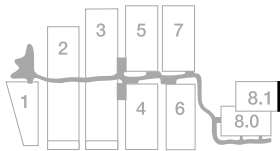

| Capacities                 |        |               |                        |
|----------------------------|--------|---------------|------------------------|
| Room                       |        |               |                        |
| 12 X                       | Type A | 30 m2         | 16 pax boardroom       |
| 2 X                        | Type B | 20 m2         | 12 pax boardroom       |
| 8 X                        | Type C | 37 m2         | 35 pax theatre         |
| all 8 can be merged into 4 |        | Type C merged | 78 m2 77 pax theatre   |
| 4 X                        | Type D | 31 m2         | 29 pax theatre         |
| all 4 can be merged into 2 |        | Type D merged | 62 m2 59 pax theatre   |
| 2 X                        | Type E | 42 m2         | 16 pax boardroom       |
| 1X                         | Type F | 60 m2         | 56 pax theatre         |
| 6 X                        | Type G | 50 m2         | 22 pax boardroom       |
| 4 can be merged into 2     |        | Type G merged | 100 m2 102 pax theatre |
| 6 X                        | Type H | 63 m2         | 28 pax boardroom       |
| 4 can be merged into 2     |        | Type H merged | 126 m2 132 pax theatre |
| 2 X                        | Type I | 75 m2         | 84 pax theatre         |
| 2 X                        | Type J | 80 m2         | 81 pax theatre         |



Apply your  
creativity,  
impact  
the world

Learn

Hang out

IBM



Explore

SAP HANA Platform  
Take a New Approach to  
Data Warehousing

SAP HANA Platform  
Get Acquainted with  
SAP HANA Academy

SAP S/4HANA

Deploy SAP S/4HANA:  
Quick Time to Value

Digital Farming  
Optimization with IoT, telematics  
and predictive analytics





HALL 7

|                   |             |
|-------------------|-------------|
| Gross Surface     | 17,000 m2   |
| Ground Resistance | 3,000 kg/m2 |
| Height            | 11 m        |





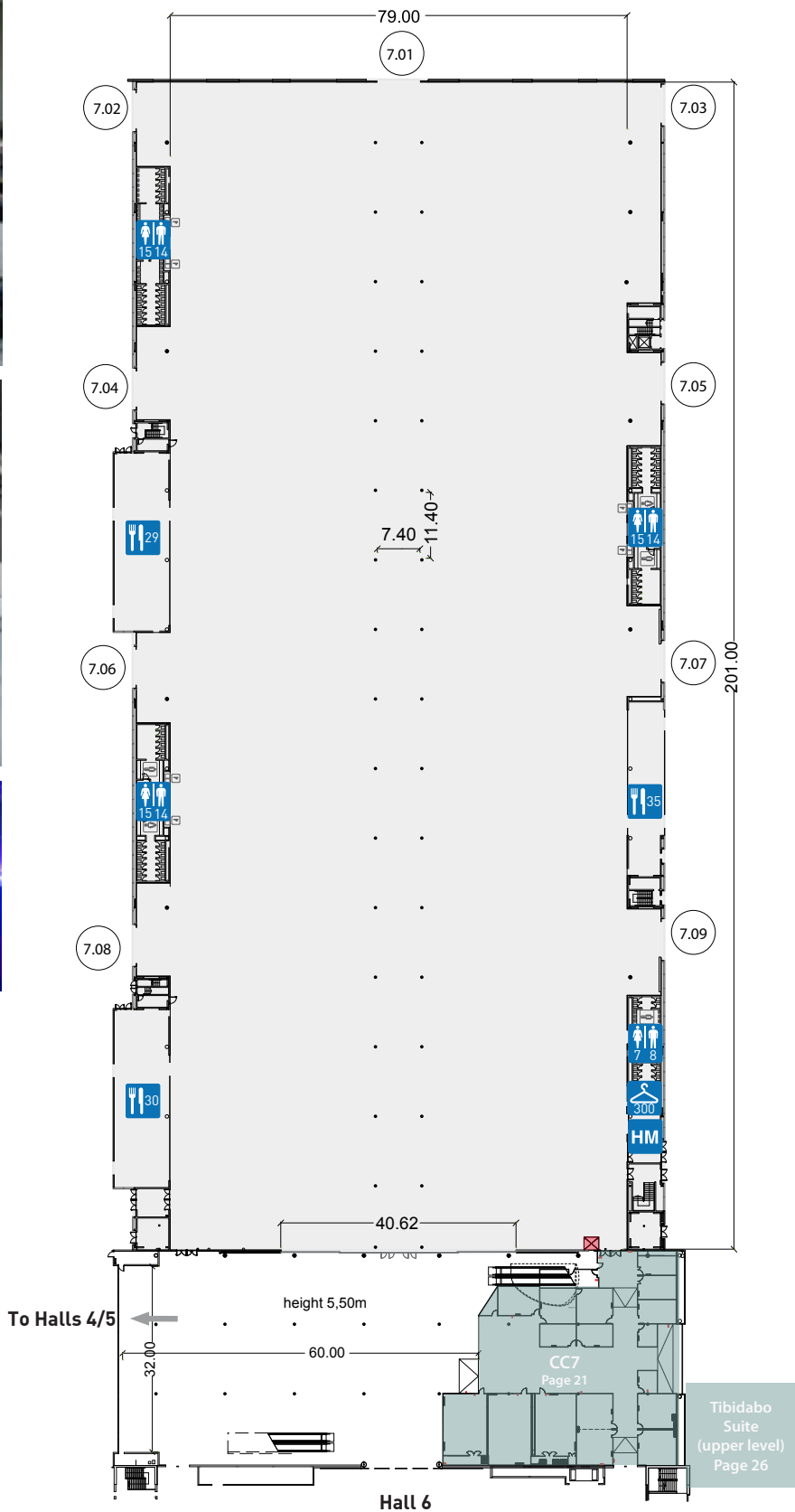
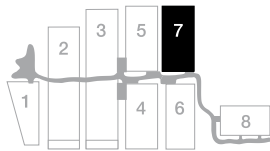

- Outlet
- Cloakroom
- WC
- HM Hall manager

|           | INDOORS | OUTDOORS |
|-----------|---------|----------|
| Outlet 29 | 100     | 140      |
| Outlet 30 | 100     | 100      |
| Outlet 35 | 80      | 140      |

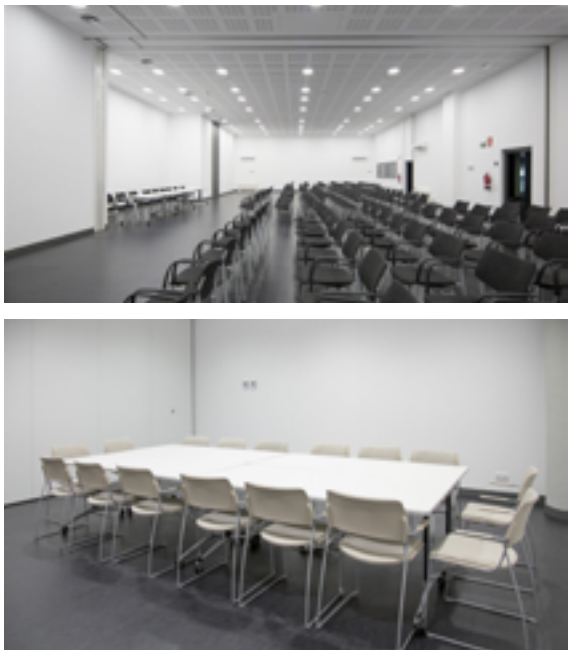
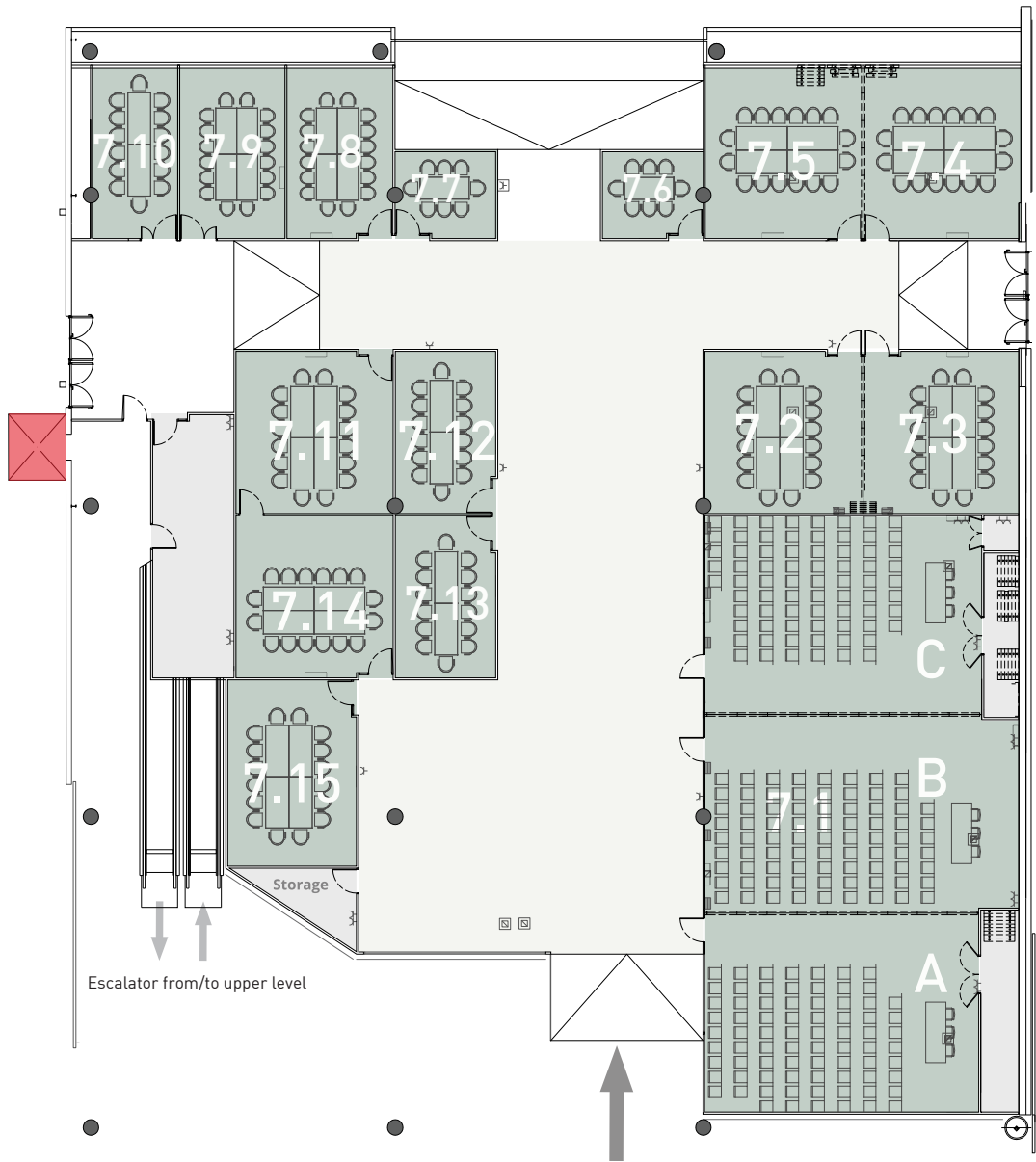

MEETING ROOMS CC7

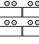

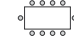
|               |       |  |  |  |  |
|---------------|-------|---|---|---|---|
| Room          |       | Theatre   | Classroom   | U shape   | Boardroom   |
| 7.1 A + B + C | 253m2 | 222   | 120   | 63  | 72  |
| A             | 81m2  | 77  | 30  | 21  | 24  |
| B             | 91m2  | 80  | 36  | 27  | 30  |
| C             | 81m2  | 74  | 30  | 21  | 24  |
| 7.2 & 7.3     | 37m2  | 20/21   | 12  | 14  | 16  |
| 7.2 + 7.3     | 74m2  | 67  | 36  | 27  | 30  |
| 7.4 & 7.5     | 40m2  | 25  | 12  | 14  | 16  |
| 7.4 + 7.5     | 80m2  | 67  | 36  | 27  | 30  |
| 7.6 & 7.7     | 13m2  | -   | -   | -   | 8   |
| 7.8 & 7.9     | 26m2  | -   | -   | -   | 16  |
| 7.10          | 21m2  | -   | -   | -   | 14  |
| 7.11          | 38m2  | -   | -   | -   | 16  |
| 7.12          | 24m2  | -   | -   | -   | 14  |
| 7.13          | 24m2  | -   | -   | -   | 14  |
| 7.14          | 38m2  | -   | -   | -   | 16  |
| 7.15          | 35m2  | -   | -   | -   | 16  |







PLENARY ROOM

Permanent structure to build a temporary plenary room of 3,600 seats extendible to 5,600 seats.

Fira Barcelona has made available an infrastructure to easily build a plenary room that can be totally customized. We are able to offer the best consultancy to find the solution needed for your event: a wide range of audiovisual services, several types of finishing, endless layouts possibilities and creative lighting.

Gross Surface 3,400 sqm  
Curtain height 10 m

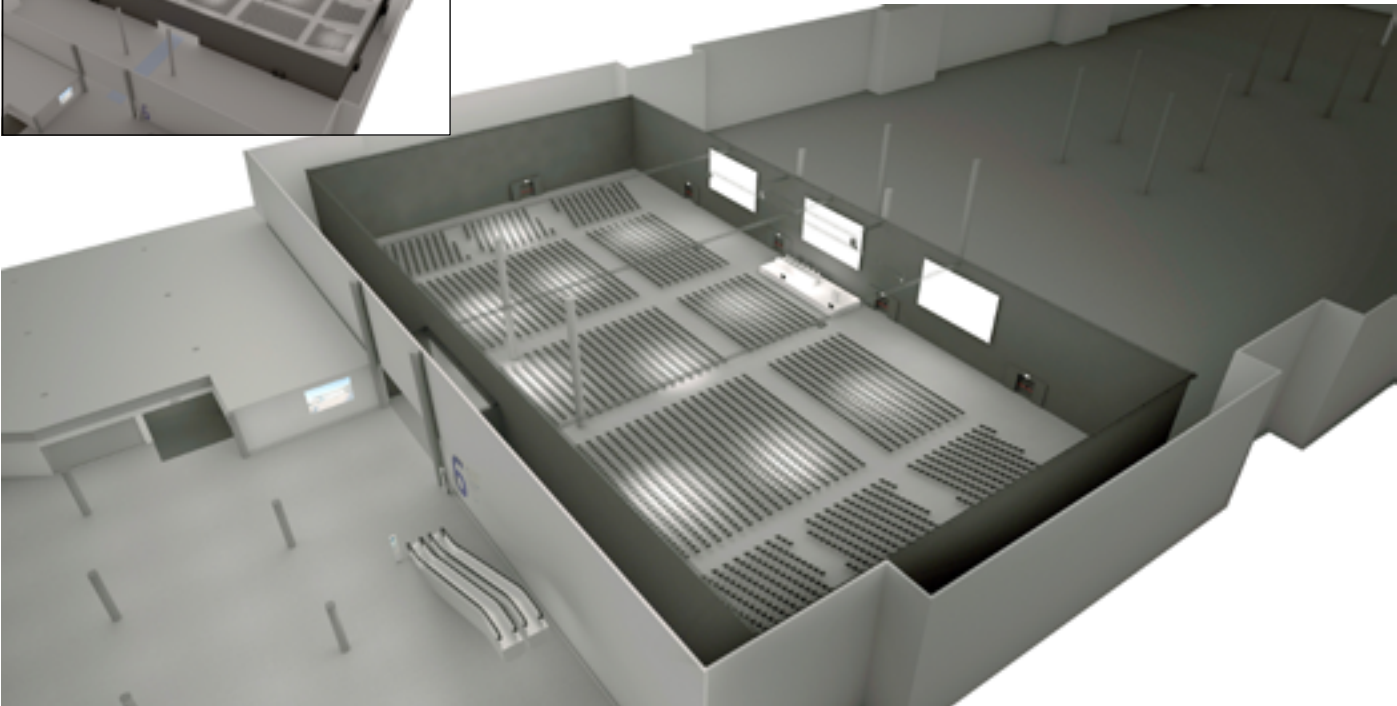
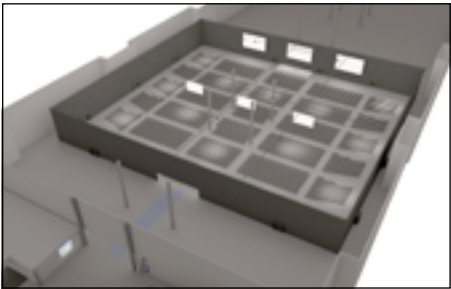

HALL 6

Gross Surface 20,000 m2  
Ground Resistance 5,000 kg/m2  
Height 12 - 15.8 m



- Outlet
- Cloakroom
- WC
- Hall manager
- Info point

FOOD OUTLET CAPACITIES

|           | INDOORS | OUTDOORS |
|-----------|---------|----------|
| Outlet 26 | 420     | -        |
| Outlet 31 | 50      | -        |
| Outlet 32 | 50      | -        |
| Outlet 33 | 50      | -        |
| Outlet 34 | 50      | -        |

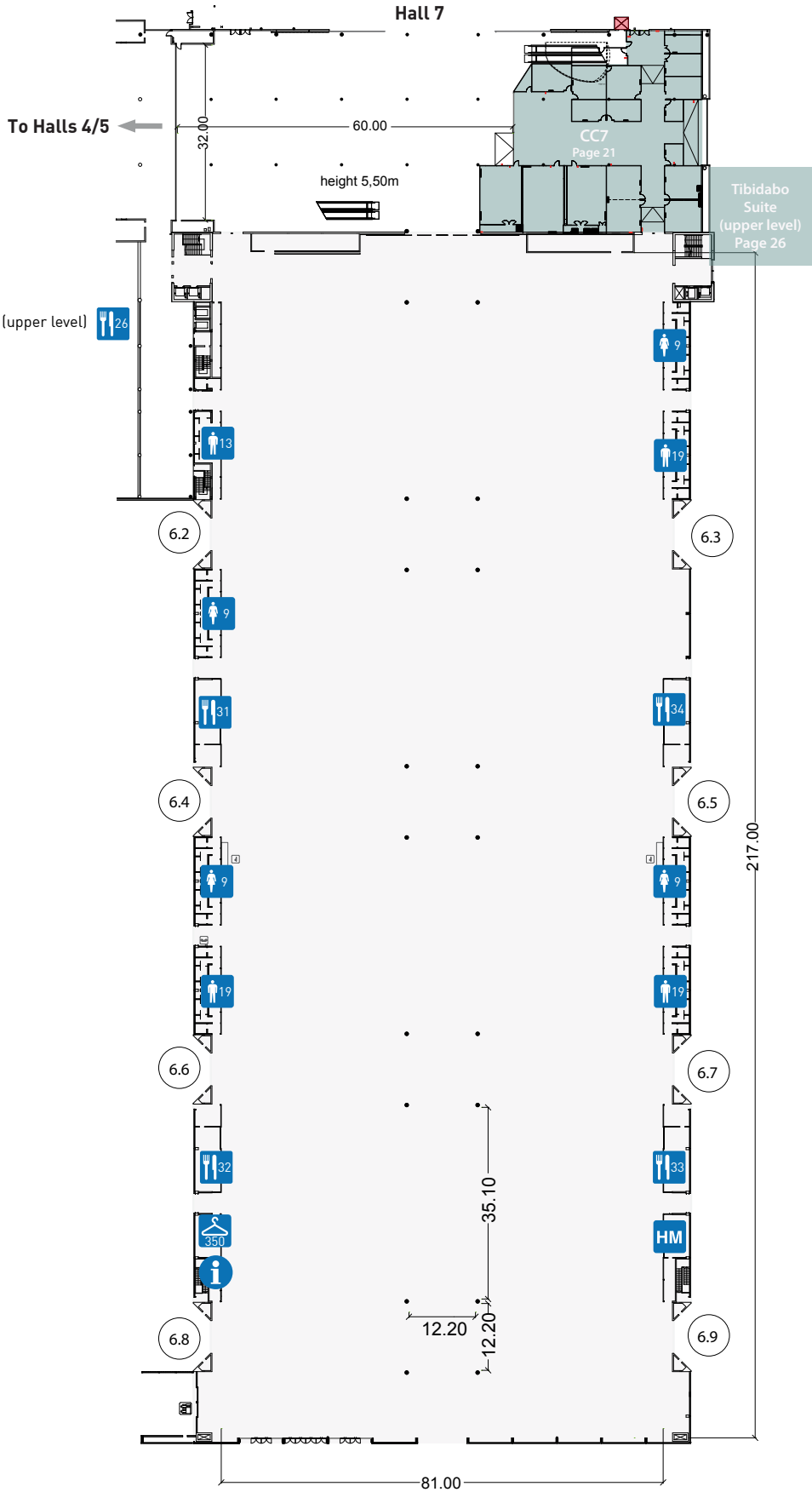
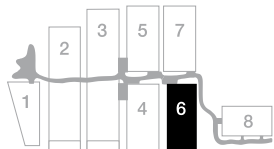



# TIBIDABO SUITE

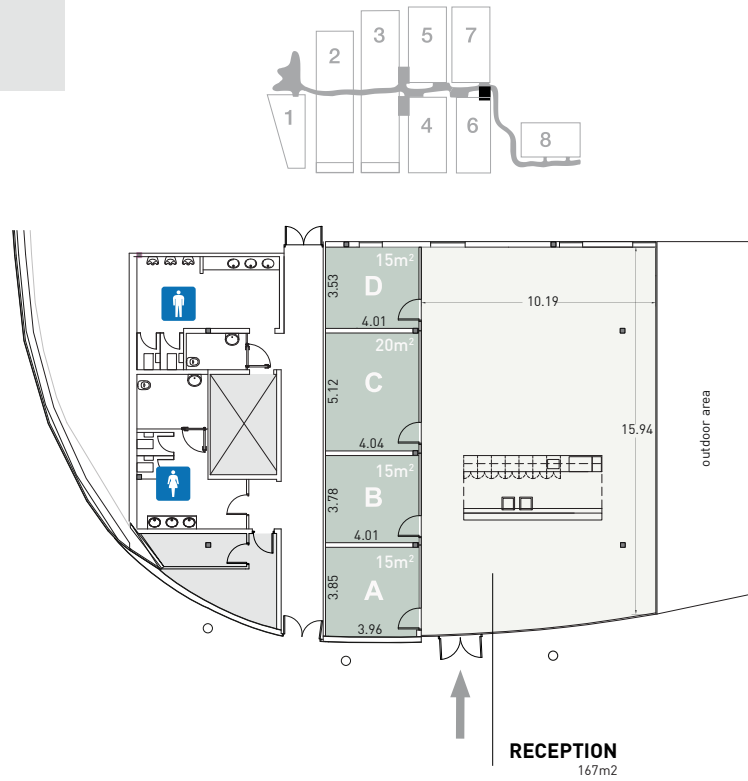

# LINK HALLS 6 and 7

Connects to Halls 3, 4 and 5

|                   |             |
|-------------------|-------------|
| Gross Surface     | 7,500 m2    |
| Ground Resistance | 1,000 kg/m2 |
| Height            | 5,50 m      |

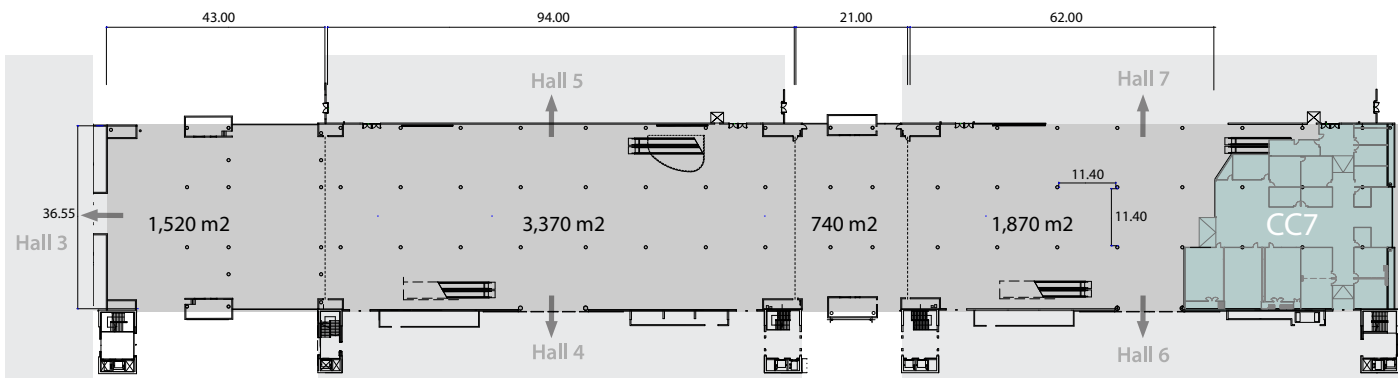
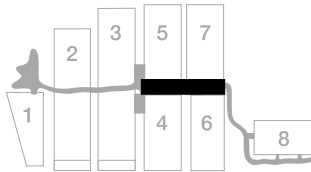

# SERVICES

Fira Barcelona is proud to introduce you to the professional services supplied by the venue together with our skillful partners. Along with its state-of-the-art venue and team, Fira Barcelona has a large and outstanding experience on organisers and exhibitors services. It can be as varied as audio-visuals, stand building, feature areas, deployment of internet, security, any possible services you might require: we have all suppliers needed and in complete synchrony. We have established partnerships with a wide range of suppliers with long, proved and strong international experience.

Fira Barcelona coordinates and monitors all their services. The fact of being strategically positioned inside the venue gives them the advantage of providing the best service, know-how on the venue logistics, a very close relation with the operations team and having the team leader sitting very near the organiser's office during build up, show days and dismantling.



# DESIGN STANDS

CUSTOM-BUILT STAND: THE IDEAL FRAMEWORK FOR DOING BUSINESS

We are specialists in creating any space you can imagine. Complete support for stand design, construction, services and logistics through a single contact for all your requirements. A single contact from start to finish: total design, construction, services and logistics support for a customized project: utilities, catering, signage, plants, furniture, a/v support rigging, telecommunications, staffing, advertising...



# ONLINE ORDERING SYSTEM

A CUSTOMIZED E-COMMERCE WEBPAGE THAT ALLOWS YOU TO SELL EVEN MORE

At ServiFira, Fira's Exhibitor Service Department, we take care of everything to make sure your involvement in the event is a complete success. In doing so, we offer you the most comprehensive and innovative catalogue of exhibitor services on the market. If your exhibitor needs furniture, plants, internet connections, staff, these can be easily ordered through an e-commerce webpage adapted to your needs.



# CATERING SERVICES

A WORLD OF MOUTHWATERING EXPERIENCES

Fira Barcelona offers you the unique cuisine of Nucló Catering. Specialists to provide high-quality standards for any scale event, from coffee breaks to events with thousands of attendees, Nucló Catering unites a flawless service combined with incredible experiences. Mediterranean or International cuisine can be delivered at any space inside Fira and also at other emblematic spaces of the city.



# AV SOLUTIONS

POWERFUL PARTNERS TO BOOST YOUR EVENT WITH ALL RANGE OF AV EQUIPMENT

Our main objective is to offer a comprehensive service with the highest quality. Fira Barcelona's partners always wants to stay ahead in both planning and solutions. Customer and commitment oriented suppliers are able to deliver the best products available in the market with constant research of the latest releases. Our services range from design and planning to the technical production and final execution of the project, supplying technical professional video equipment, computers, sound, lighting and translation.



# OTHER SERVICES

ANYTHING YOU NEED

We can also offer event-related services such as carpet, rigging services, signage and advertising, design companies for feature areas, shell scheme stands and also support staff as hostesses, security and cleaning. Fira Barcelona boasts a series of highly-qualified teams to cover every possible requirement of an event. From the ICT or Catering to Exhibitor Services Department, Fira Barcelona puts everything in gear to ensure the success of every event.





**Fira Barcelona**

[guestevents@firabarcelona.com](mailto:guestevents@firabarcelona.com)

[www.firabarcelona-guestevents.com/hall8](http://www.firabarcelona-guestevents.com/hall8)

+34 93 233 20 00